

**MAIN FLOOR**  
**2045 SQ. FT.**  
 9'-6" CEILING HEIGHT



250-884-9753  
 matt@propermeasure.com  
 www.propermeasure.com

**Sotheby's** | **Canada**  
 INTERNATIONAL REALTY

**LOWER FLOOR**  
**1349 SQ. FT.**  
 9' CEILING HEIGHT

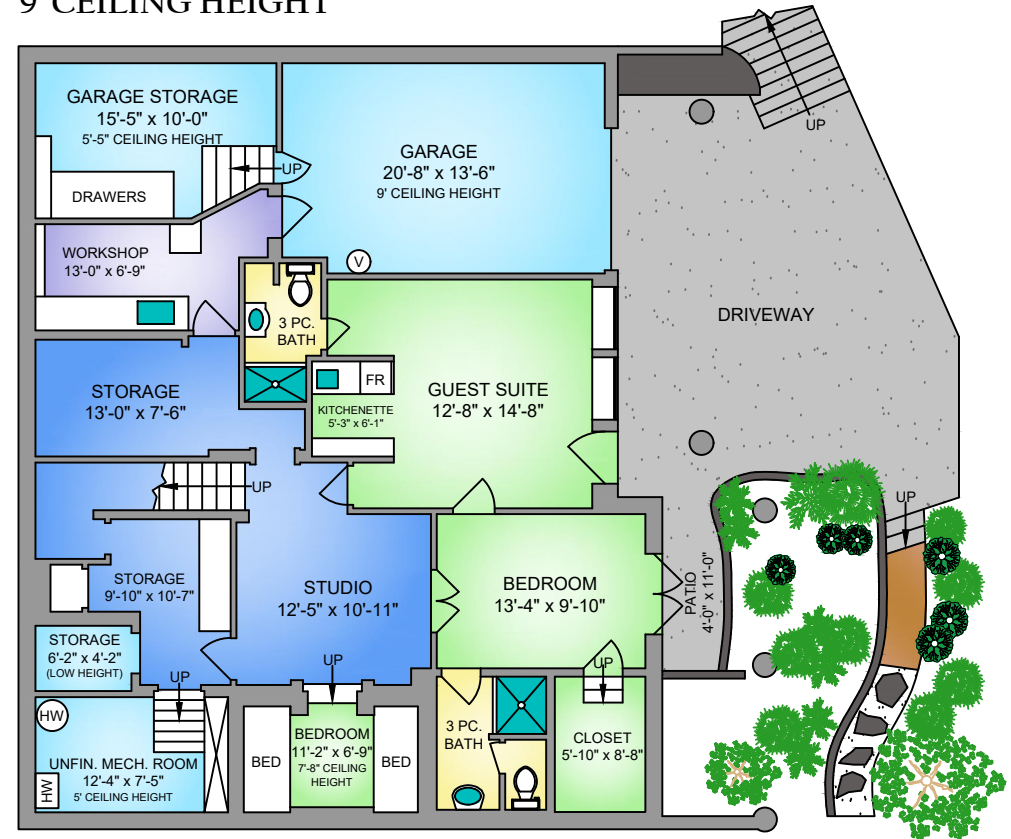

NORTH

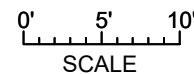
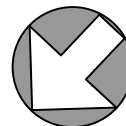

1239-B TATTERSALL DRIVE DECEMBER 21, 2021				
PREPARED FOR THE EXCLUSIVE USE OF THE MACLEOD GROUP PLANS MAY NOT BE 100% ACCURATE, IF CRITICAL BUYER TO VERIFY.				
FLOOR	AREA (SQ. FT.)			
	FINISHED	UNFINISHED	GARAGE	DECK / PATIO
MAIN	2045	-	-	365
LOWER	1349	146	487	42
<b>TOTAL</b>	<b>3394</b>	<b>146</b>	<b>487</b>	<b>407</b>